

SYSTEM OPTIONS

- AU-102 Biometric Authentication Unit
- AU-201H HID Proximity Card Reader
- Banner Paper Guide MK-713
- C652 Series/C360 Series Fax Kit
- Copy Desk DK-507
- Copy Guard Kit SC-507
- External Keyboard
- Fax Board FK-502 (2nd fax Line)
- Fiery Image Controller IC-412 (C360/C280)
- Floor Finisher FS-527
- Inner Finisher FS-529
- i-Option LK-101 v2
- i-Option LK-102
- i-Option LK-105
- i-Option Memory Upgrade Kit UK-203
- Job Separator Tray JS-505
- Job Separator Tray JS-603 (3rd Output Tray for FS-527)
- Keyboard Holder KH-101
- Local Interface Kit EK-604
- Local Interface Kit EK-605 (with Bluetooth Support)
- Mount Kit MK-720 for FK-502
- Original Cover OC-509
- Paper Feed Cassette PC-107
- Paper Feed Cassette PC-207
- Large Capacity Cassette PC-408
- Punch Kit PK-517 for FS-527
- Reversing Automatic Document Feeder DF-617
- Saddle Stitcher SD-509 for FS-527
- Spare TX Marker Stamp 2
- Stamp Unit SP-501
- Video Interface Kit VI-505
- Working Table WT-506
- Working Table WT-507 (Side Panel Kit)

bizhub C360/C280/C220

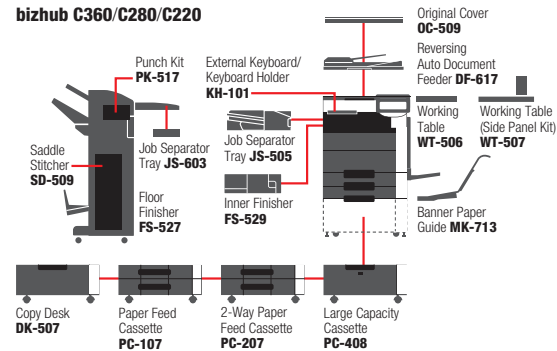

TARGET

Aims

- To surpass the competitors' line-up of new-generation color devices
- To stimulate replacement of color machines in the mid-speed range
- To fulfill monochrome product requirements
- To increase Segment 2/3 Market Share – a series to replace existing B/W machines
- To strengthen Konica Minolta as a strong solution provider

Sales targets to look for:

- Mid-volume office environments
- Users of medium-speed B/W or color machines primarily in Segment 2/3
- Users who need mainly B/W output
- Users with graphic arts needs (C360 & C280 with IC-412 Fiery® Controller)

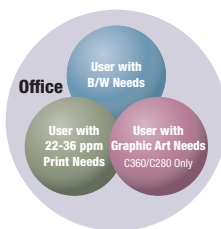

OUR COMMITMENT TO ENVIRONMENTAL SUSTAINABILITY

Konica Minolta keeps its long-time commitment to environmental sustainability with a 360 degree perspective – through its policy, products, programs and people. Our global approach with a local touch harmonizes our business practices with the environment that we all share.

Konica Minolta publishes its annual Environmental Policy and Environmental Report to share its commitment, accomplishments and goals in protecting the environment.

We strive to manufacture products that attain the lowest impact on the environment with the highest efficiency in the office. Through our exclusive Simitri® HD toner and fusing technology for reducing power consumption; 100% duplex capability for paper efficiency and use of recyclable plastics from packaging materials to our devices, Konica Minolta truly shows its loyalty and responsibility to protecting the environment not only for today but also for future generations.

Besides participating in global environmental programs like Energy Star, Eco-Mark, Blue Angel and EcoLeaf, Konica Minolta sustains its own recycling, manufacturing and procurement programs. The Clean Planet Program in the United States ensures recycling through our recycling centers.

Konica Minolta employees around the world share our dedication to protect the environment by actively participating in corporate environmental programs and initiatives.

We, at Konica Minolta, are committed to achieving a sustainable environment.

Please refer to mykonicaminolta.com for more information.

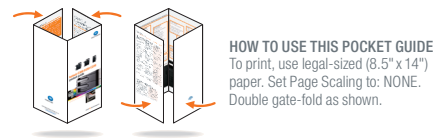

KONICA MINOLTA

KONICA MINOLTA BUSINESS SOLUTIONS U.S.A., INC.

100 Williams Drive, Ramsey, NJ 07446

www.CountOnKonicaMinolta.com

www.kmbs.konicaminolta.us

Item #: C360PG 9/09



ENHANCEMENTS

bizhub C360/C280/C220 vs. bizhub C353/C253/C203 Series

Enhancements	C360/C280/C220	C353/C253/C203
Copy Speed Simplex and Duplex (B/W and Color)	C360: 36/36 C280: 28/28 C220: 22/22	C353: 35/35 C253: 25/25 C203: 20/20
Max. Scan Speed (B/W and Color)	70/70 (300 dpi)	70/70 (300 dpi)
Scan Speed (B/W and Color)	42/42 (600 dpi)	55/51 (600 dpi)
Warm Up (seconds) (B/W and Color)	C360/C280: 27/35 C220: 22/27	C353: 30/41 C253/C203: 27/37
FCOT (seconds) (B/W and Color)	C360/C280: 5.8/7.7 C220: 7.5/11	5.9/8.5
Card Shot	Std.	No
Standard Memory/HDD	2 GB/250 GB	1 GB/60 GB
CPU	C360/C280: 1 GHz C220: 667 MHz	C353/C253/C203: 1 GHz
Finishing Options	FS-527 Floor Finisher FS-529 Inner Finisher JS-505 Job Separator	FS-519 Base Finisher FS-609 Floor Booklet Finisher JS-505 Job Separator
Bluetooth® Printing	Yes	No
Outline PDF	Yes	No
Searchable PDF (with Optional LK-105 i-Option Kit)	Scanning feature to convert a hard copy scan document into a searchable PDF with OCR capability	No
USB Interface	4 Standard Ports EK-604/EK-605 (1 Optional Port)	EK-603 (2 Optional Ports)
Advance Security Functions:	HDD Encryption (Std) Copy Guard/Password Copy (Opt.)	HDD Encryption (Opt.) No
Fiery® Support	IC-412 (for C360 and C280)	IC-409 (for C353 and C253)



bizhub C360/C280/C220 pocket guide



full color printer/copier/scanner/fax

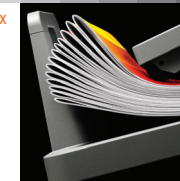

COUNT ON KONICA MINOLTA

bizhub

C360/C280/C220

Superiority over the Competition

► Industry Leading

- Improved first copy out time and first print out time: 7.7 sec (C360/C280 color)
- Faster warm-up time: 35 sec (C360/C280 color)
- High-speed color scanning (70 opm)
- Superior performance (print, scan and multi-access)
- Industry-leading minimal downtime
- Industry-leading quiet operation
- Consistent B/W image quality based on an Auto-Refining Developing System
- Maximum total paper capacity (plain paper): Standard 1,150 sheets/ Up to 3,650 sheets with options
- All trays support thick paper (Up to 140 lb.)
- RADF paper weight: 9.31 lb. to 55.88 lb.
- Multiple bypass tray paper weight: Up to 100 lb. cover
- Multi-position stapling and hole punching: Up to 50 sheets with optional 2/3-Hole Punch (PK-517) or optional Saddle Stitching (SD-509) (for FS-527)
- Multi-position stapling: Up to 50 sheets (FS-527 or FS-529)
- Center staple & fold: 15 sheets/60 pages (FS-527 + SD-509)
- Banner print support
- Black Over Print (PS Driver)
- Auto-Trapping (PS Driver)
- PDF version 1.7 support
- Standard PCL/PS/XPS driver
- Print drivers feature MyTab for individual customization
- Non-Image Area Erase copy feature (Sky Shot)
- Card Shot
- Watermark feature in copy mode
- Scan-to-Me, Scan-to-Home
- Enhanced User Box feature
- Copy Guard/Password Copy
- Import/Export File to/from User Boxes
- Searchable PDF
- Color Internet Fax
- Bluetooth® printing
- Standard hard disk data encryption
- Support for HID Proximity Card Authentication
- Support for Biometric Authentication
- NDS authentication over TCP/IP
- Support for color universal design
- Quiet operation
- High energy-saving device
- Increased consumable life

MAJOR DIFFERENCES FROM PREVIOUS MODELS

NEW FEATURES

Robust Security Features

- New AU-102 Biometric Authentication Unit
- Scan-to-Me and Scan-to-Home
- IEEE 802.1X support
- NDS authentication over TCP/IP
- Standard HDD Encryption
- Copy Guard/Password Copy

Facilitating the Seamless Office

- Color Internet Fax
- Enhanced user box feature with enhanced operability
- Native XPS and Windows Vista support
- Bluetooth® printing

B/W Machine Features

- Non-Image Area Erase feature (Sky Shot)
- Watermark feature supported in Copy mode
- Card Shot

Enhanced Features from Previous Models

- Enhanced overlay feature
- New page management log features

Expanded Color User Interface

- Enhanced Color Preview/Thumbnail features
- Expanded Web Browser functionality (AJAX support)
- Animated end-user operating procedures
- Improved display of misfeed locations

Choice of Three Output Options:

- FS-527 Floor Finisher:** Industry leading slim design, quiet operation, high productivity
- FS-529 Inner Finisher:** Compact design, three staple position, high productivity
- JS-505 Job Separator Tray**

Newly Developed MFP Controller

CPU: C360/C280: MPC8533E 1 GHz
C220: MPC8533E 667 MHz

Main Memory: 2 GB (Standard)
+ 1 GB (Optional)

HDD: 250 GB (Standard)

- Further improvements for industry-leading uptime
- Three image stabilization controls to suit user's operating environment
- Dedicated image stabilization control for B/W images.
- Industry-leading first copy out time (Color)
- Reduced warm-up time after main power switch turned on
- Improved print performance
- Enhanced Emperon® features
- New image processing ASIC achieves industry-leading image quality

RADF (Optional)

- C652 Series RADF design optimized for the C360 Series (Optional)
- Paper feed speed changed and acceleration speed reduced
- Reduced vibration noise by changing motor frequency
- Reduced operating noise by using brushless motors
- Belt drive replaces gears used in previous models
- 70 opm scan speed

Transfer System

- Industry-leading transferred image quality
- Transfer image quality is not highly dependent on paper quality
- Transfer system lifetime increased by 2 times
- Smoother paper feed performance

Enhanced Service Features

- Support for banner printing account calculation
- Supports customized LCD boot up screens
- Firmware updates via USB port
- New Service Mode features

Improved Access to USB Interface

Control Panel

- Reduced depth and improved attachment and removal
- Large 8.5" Color Touch-Screen with thumbnail preview

Second Fax Board

- Housed inside cover

Drum Units and Developing Units

- Separate black drum and black developer offer highly increased consumable life
- Separate color drums and color developers offer highly increased consumable life
- Auto-Refining Developing System
- Stable B/W images via Auto-Refining Developing System

Energy Saving

- C360/C280/C220 are industry leading energy-saving devices
- Typical Energy Consumption (TEC) values increased from up to 33% compared to previous models

Quiet Operation

- Industry-leading quiet operation
- Operating and non-operating noise further reduced

Significantly Reduced Setup Time

Environmentally Friendly Design

- Low power consumption
- Industry leading quiet operation
- Resource-friendly design enables use of recycled materials
- Compliance with environmental standards

Multiple Bypass Unit

- Supports banner paper*
- Paper weights up to 100 lb. Cover

Toner Replenishment

- Color/Black: Mixed carrier filling for Auto-Refining Developing System support



* With optional FS-527 Floor Finisher, FS-529 Modular Staple Finisher, JS-505 Output Tray or with no finishing options attached.

PRODUCT CONCEPT

Konica Minolta's flagship MFP's with emphasis on Segment 2/3 color upgrades and B/W replacement.

Successor models to the C353/C253/C203. These next-generation MFPs offer seamless connectivity to leading-edge offices by supporting a variety of networking needs with superior performance, high image quality, high reliability and low TCO. This new series strives for an even higher level of perfection by building on the strengths that made the predecessors such outstanding products.

Appeal Points

This bizhub series achieves an uncompromising level of reliability, performance, and true ease-of-use for the user, establishing it as the main machine in the office.

- Aiming specifically at B/W replacement
 - Same level of specifications, functions and options on all 3 models
 - More competitive system pricing level
 - More competitive total B/W and Color CPC than current models
 - Same reliability, productivity and installation ease on all 3 models
 - Superior B/W image quality
- Industry-leading productivity (first copy out time, warm-up time, scanning, printing, multi-job performance, image stabilization)
- Industry-leading high image quality
- Further improvements in reliability and durability
- Enhanced Emperon® features
- Seamlessly connects tasks in the office, allowing documents to be converted into electronic data, distributed, received, shared and utilized
- Improved usability by accurately meeting market needs
- Excellent environmental performance (energy-saving, quiet operation)
- New-generation bizhub design
- 8.5" Touch-Screen Control Panel with color user interface (color-based universal design, animation guidance)